

Features and benefits:

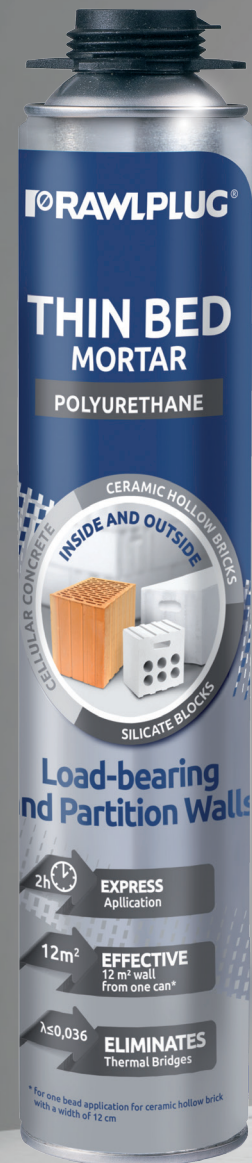

ONE CAN REPLACES 25 KG OF MORTAR - SAVES TIME AND REDUCES THE INSULATION WEIGHT MADE COMPARED WITH TRADITIONAL METHODS

ONE CAN IS ENOUGH TO COVER 8-12 M² OF INSULATED SURFACE - HIGHLY EFFICIENT

EXCELLENT ADHESION TO COMMON BUILDING SUBSTRATES AND INSULATING MATERIALS

WORKS AT LOW TEMPERATURES (UP TO -5°C) – LONGER WORKING, SEASONABLE APPLICATION

HIGH INITIAL FORCE & EXCELLENT INSULATION - DOES NOT CREATE THERMAL OR ACOUSTIC BRIDGES

APPLICATIONS

Thin Bed Mortar PU based, is designed for: Internal and External walls load-bearing & partition walls of:

- Aerated Concrete
- Silicate Blocks
- Hollow Ceramic

High dimensional tolerance class TLMB (Flatness/height deviation not larger than 3 mm per running meter)

Also excellent adhesion to typical construction materials, such as:

- Cellular concrete blocks
- Ceramic bricks
- Hollow blocks
- Concrete
- Acrylic and mineral plasters
- Wood
- Metal
- Foamed polystyrene
- PVC and rigid PUR foams

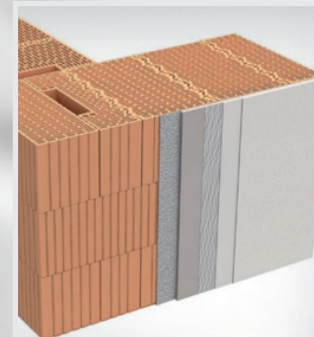

Scan QR code to see more:



RAWLPLUG LTD.
Skibo Drive
Thornliebank Industrial Estate
Glasgow G46 8JR

tel: +44 (0) 141 638 7961
fax: +44 (0) 141 638 7397

email: rawlinfo@rawlplug.co.uk
web: www.rawlplug.co.uk

RAWLPLUG®



**R-RPP
Mortar**

**THIN BED MORTAR PU
NEW POLYURETHANE MORTAR**

Wide array of advantages

Installation and application:

Product Information Installation

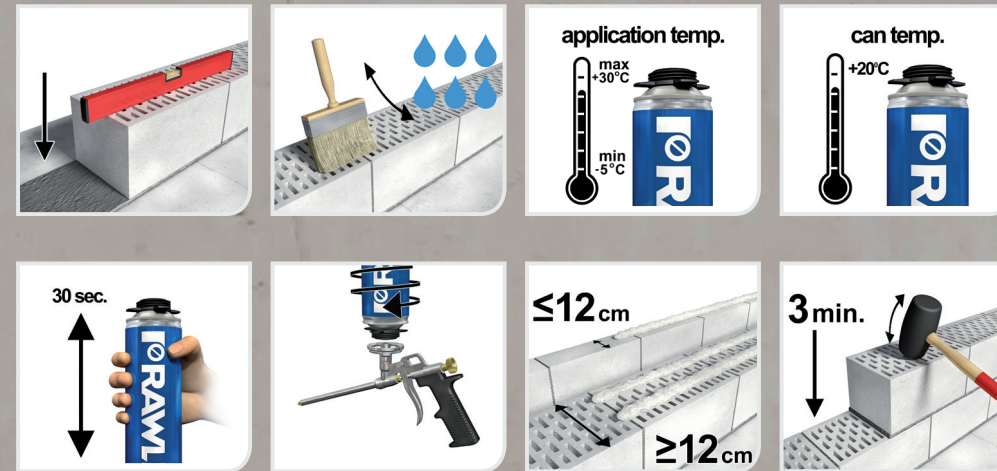

- The working surfaces must be free of dust, debris and other materials that would impair the bond strength. Moisten the working surface with water, using a brush or spray. Polyurethane mortar should be protected on surfaces which may become dirty.
 - Optimal can temperature is +20°C. A cold can should be warmed or kept at room temperature for a minimum of 24 hours before application.
 - Wear protective gloves.
 - Attach gun applicator and shake can vigorously for 30 seconds.
 - Working position is always upside down.
 - Apply the mortar:
 - one bead in the middle of the block with a width of 12 cm
 - two parallel beads for blocks with a width exceeding 12 cm
 - Apply the mortar on the long side of the block keeping 3 cm distance from the side edge of the block forming:
 - bead with required diameter 3 cm for aerated concrete blocks
 - bead with required diameter 5 cm for hollow ceramic and silicate blocks
 - Blocks should be put on applied mortar up to 3 min after mortar application.
 - The block with the mortar should be pressed slightly in order to obtain a thin slit evenly spread on the block surface.
 - To achieve the desired accuracy, the blocks should be levelled.
- Blocks can be horizontally corrected within 3 minutes by up to 0.5 cm without detaching them from the wall.**
Stabilise the blocks with a rubber hammer.

Mortar yield from one 750 ml can

The width of the masonry block	Recommended number of beads	Application of Horizontal [m ²]	Application vertically and horizontally [m ²]
≤ 12 cm	1	10-12	5-8
≥ 12 cm	2	5-8	3-4

Material	Type of application /number of beads	Application of Horizontal [m ²]	Application vertically and horizontally [m ²]
Aerated Concrete Block	block up to 12 cm width/1	10	8
	block over 12 cm width/2	4,8	3
Ceramic Hollow Block	block up to 12 cm width/1	10 - 12	7 - 8
	block over 12 cm width/2	5 - 6	3 - 4
Silicate Blocks	block up to 12 cm width/1	10	6 - 7
	block over 12 cm width/2	5,2	3,2



2h - EXPRESS
Application



EASY
applications



12m²
EFFECTIVE
12 m² wall from one can



Saves
TIME & MONEY

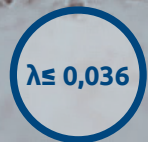

λ ≤ 0,036
ELIMINATES
Thermal bridges



EXTENDS
building season